

# #20 Gas Candy Stove

## Savage Bros Traditional Candy Stove



### PRODUCT SPECIFICATIONS

Dimensions	27.1" diameter x 29.7" width x 27.5" height
Body	Stainless steel outer shell
BTU Rating	80,000 BTU
Gas Line	1/2 NPT input pipe
Burners & Jets	Cast iron - 32 jets
Kettle Size	Best - 20" x 11" (91 lbs) Maximum - 20" x 16" (124 lbs)
Weight of Unit	67 lbs
Warranty	1 year limited product warranty
Certification	CSA approved for USA & Canada

### RELIABLE & DURABLE CLASSIC CANDYMAKER

The #20 Gas Candy Stove is one of Savage Bros' classic candy stoves that follows the traditional method of cooking. This product is made built-to last with its high-quality metal construction.

The #20 Gas Candy Stove is ideal for countless confections such as caramel, gummies, fudge, toffee, brittle, and more!

### KEY FEATURES

- 1 Utilizes natural gas or liquid propane
- 2 Uses an even heat jet burner system made of cast iron and 32 jets for consistent heat distribution around the kettle
- 3 Made with sturdy stainless-steel outer shell and cast aluminum legs
- 4 Insulated double-wall shell for a steady heat transfer while cooking
- 5 Safety gas pilot ensuring peace of mind at every use



### OPTIONAL ACCESSORIES

- Copper and Stainless Steel 11" & 16" Kettle
- Digital Thermometer
- Portable Agitator

MADE  
IN USA



## DIMENSIONAL DRAWINGS

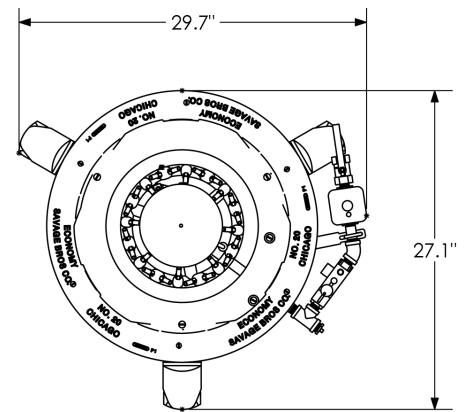
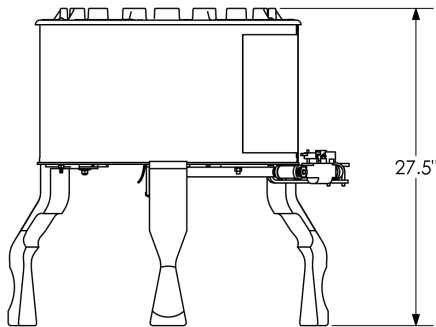
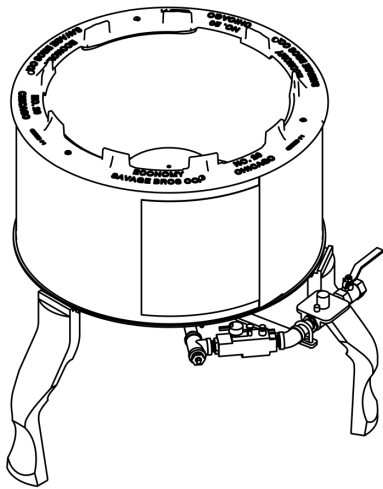

**ACCESSORIES:** Not included in the #20 Gas Candy Stove Pricing

## OPTIONAL ADD-ONS



Copper & Stainless Steel Kettle

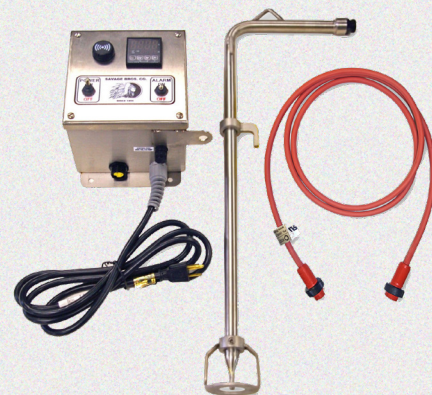

Digital Thermometer

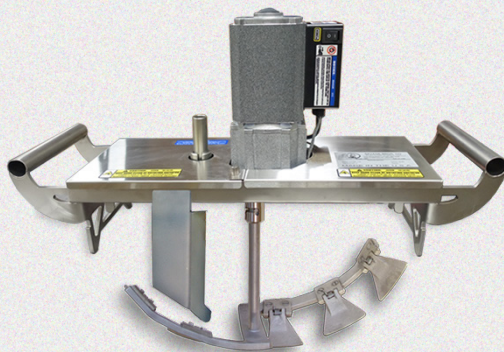

Portable Agitator